

Jedburgh Intergenerational Community Campus

Newsletter Number 01 – February 2018

Welcome to our newsletter. Our aim in producing this occasional newsletter is to keep you informed about the progress of the project and what you can expect to see happening on and around the site in the weeks to come.

What We're Building

This project will involve the removal of trees and relocation of material excavated from the existing ground to provide a levelled area, installation of new drainage and retaining walls to allow the formation of the new car park and campus building. Demolition works will also take place at the Parkside Primary School to allow a new access road to be formed and new access routes around the building will be created.

The new facility will serve 2 to 18 year olds as well as providing further education opportunities and community facilities for the town.

Jedburgh intergenerational community campus will replace Jedburgh Grammar, Howdenburn and Parkside primary schools, and will be located on land at Hartrigge Park.

The campus will have provision for nursery, primary and secondary school children, and facilities would include a multi-use games area, 2G hockey pitch, 3G sports pitch, running track, external changing pavilion and rural skills area

Works are scheduled for completion in August 2020

Initial Works

Site establishment, fencing and hoarding

Clearing land of obstructions and protecting trees that will remain.

Utility services / drainage diversion

Partial demolition of Parkside Primary School

Formation of access roads

Environment & Community

BAM are committed to helping the environment and community. This includes reducing our carbon emissions, recycling and wherever possible diverting waste from landfill. Green credentials of the project will include minimizing all water, dust and noise pollution as much as possible. Keeping the community up to date with notice boards. Re-using, rehoming and recycling as much material as possible.



Jedburgh Intergenerational Community Campus

Newsletter Number 01 – February 2018

The site team

Construction Director: Martin Cooper
Construction Manager: Malcolm Keillor
Project Manager: David Brodie
Commercial Manager: Alistair Hynd
Senior project surveyor: Garry Evans
Assistant Project Surveyor: Mathew Smith
Senior Site Manager:
Senior Site Manager / Liaison Contact:
Assistant Site Manager: Chris Smart
Site Engineer:
M&E Coordinator: Bruce Laing
Project Planner: David Carson
Site Administrator:
Our partners:
Client: Scottish Borders Council
Developer:
Project Management:
Architect: Stallan-Brand
Structural Engineer: Goodson Associates
Building Services Engineer: Davie + McCulloch
Principal Designer:
Project Quantity Surveyor:

About BAM

BAM Construction is part of BAM Construct UK which is one of the country's largest construction services organisations with a turnover of more than £900 million. We operate throughout England, Scotland and Wales. Our European parent company is Royal BAM Group which employs over 25,000 people worldwide and has a turnover of €7billion.

Other ongoing BAM Projects

Edinburgh Airport Terminal Expansion
V&A Museum Dundee
CALA Donaldson's College Residential Development
OLSP High School
Barrhead High School, Phase 2
Levenmouth Academy Phase 2
The Waid Community Campus Phase 3
Capital Square Development

Considerate Construction

BAM are committed to being a good neighbour and to being clean, respectful, safe, environmentally conscious, responsible and accountable. Our site is independently inspected by the considerate constructors scheme to make sure we live up to these aims.

We try to work in a way that causes as little inconvenience as possible to our neighbours. We apologise for any unavoidable nuisance that may be caused during the work.

Any comments/complaints/suggestions are welcomed via our Facebook page or by giving us a call and speaking to a member of the site team.

Please help us with safety

Construction sites can be dangerous. At BAM our top priority is the health and safety of everyone who works on our sites, the public and the local community affected by our work. If you need to contact us, please ring us or call the site office but do not enter the site.

Please make any children in your care aware that our building site is not a playground and that they must not enter the site. Thank you for your co-operation.

Contacting the site team:

If you have any questions or concerns about what's happening at the site, please call us or email

Tel: 07775540731

Email: dbrodie@bam.co.uk

For more details about BAM visit:
www.bam.co.uk

 Partial demolition of Parkside Primary

 Jedburgh Circular Route

 Site Access Route

 Evo Unit

BAM Directional Signage Guide

1. BAM Site Next Right
2. BAM Site Next Left
3. BAM Site Turn Right
4. BAM Site Straight On
5. BAM Site Turn Left
6. BAM Site Turn Left
7. BAM Site Turn Right



Contact

Jedburgh ICC

Drawing Title

Traffic Management Plan
Weeks 1-3

Drawing No.

Revision

Ref: MK/SC Date: 28/01/18

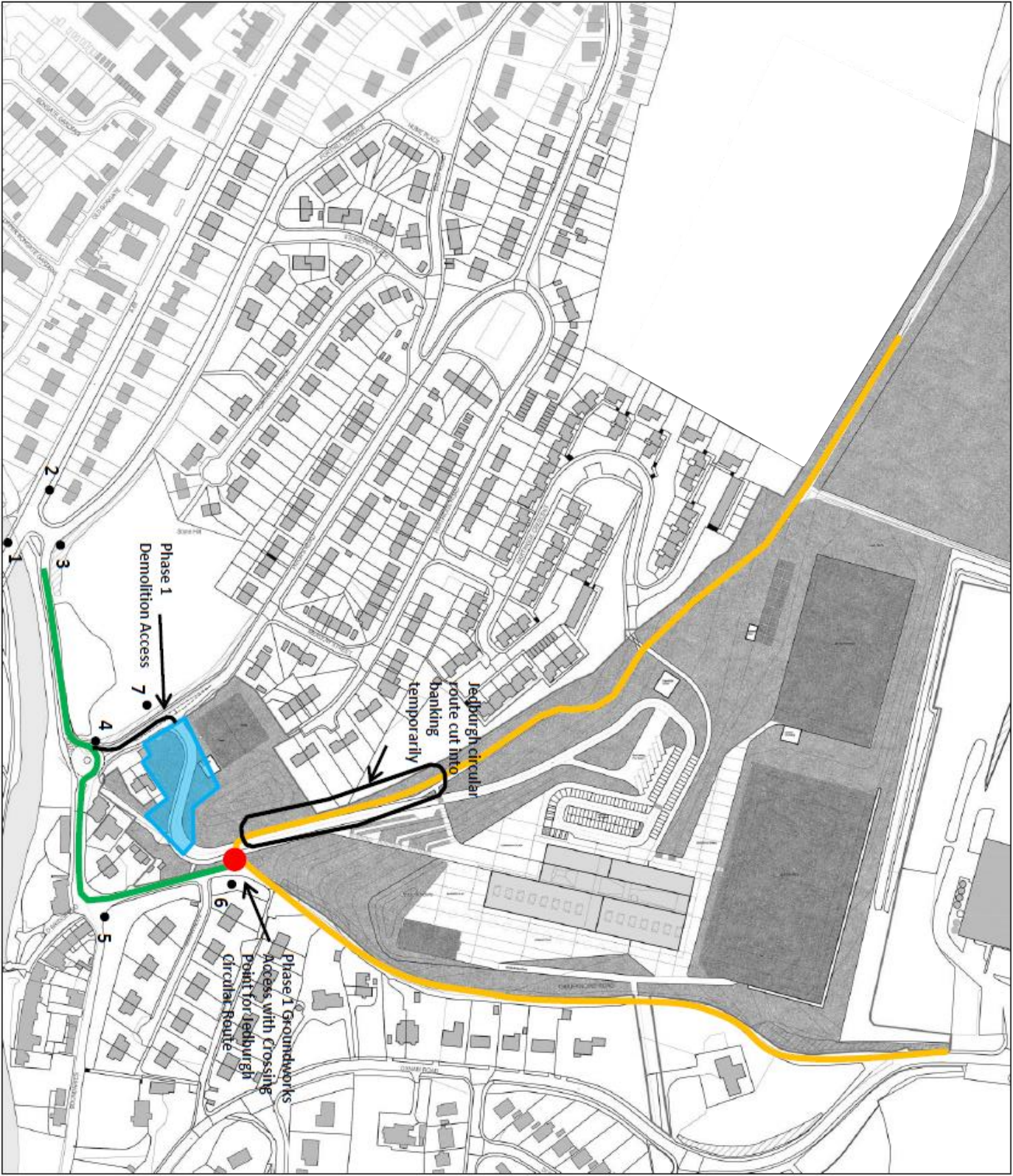

Notes

Jedburgh Circular Route

Site Access Route

Temporary Compound

Vehicle Gate

Pedestrian Gate

Heads Fencing

Formation of main access road and parking following cut & fill works

BAM Directional Signage Guide

1. BAM Site Next Right
2. BAM Site Next Left
3. BAM Site Turn Right
4. BAM Site Straight On
5. BAM Site Turn Right



Context

Jedburgh ICC

Drawing Title

Traffic Management Plan
Weeks 3-30 Access Road

Drawing No.

Revision

Ref: MK/SC Date: 18/01/18

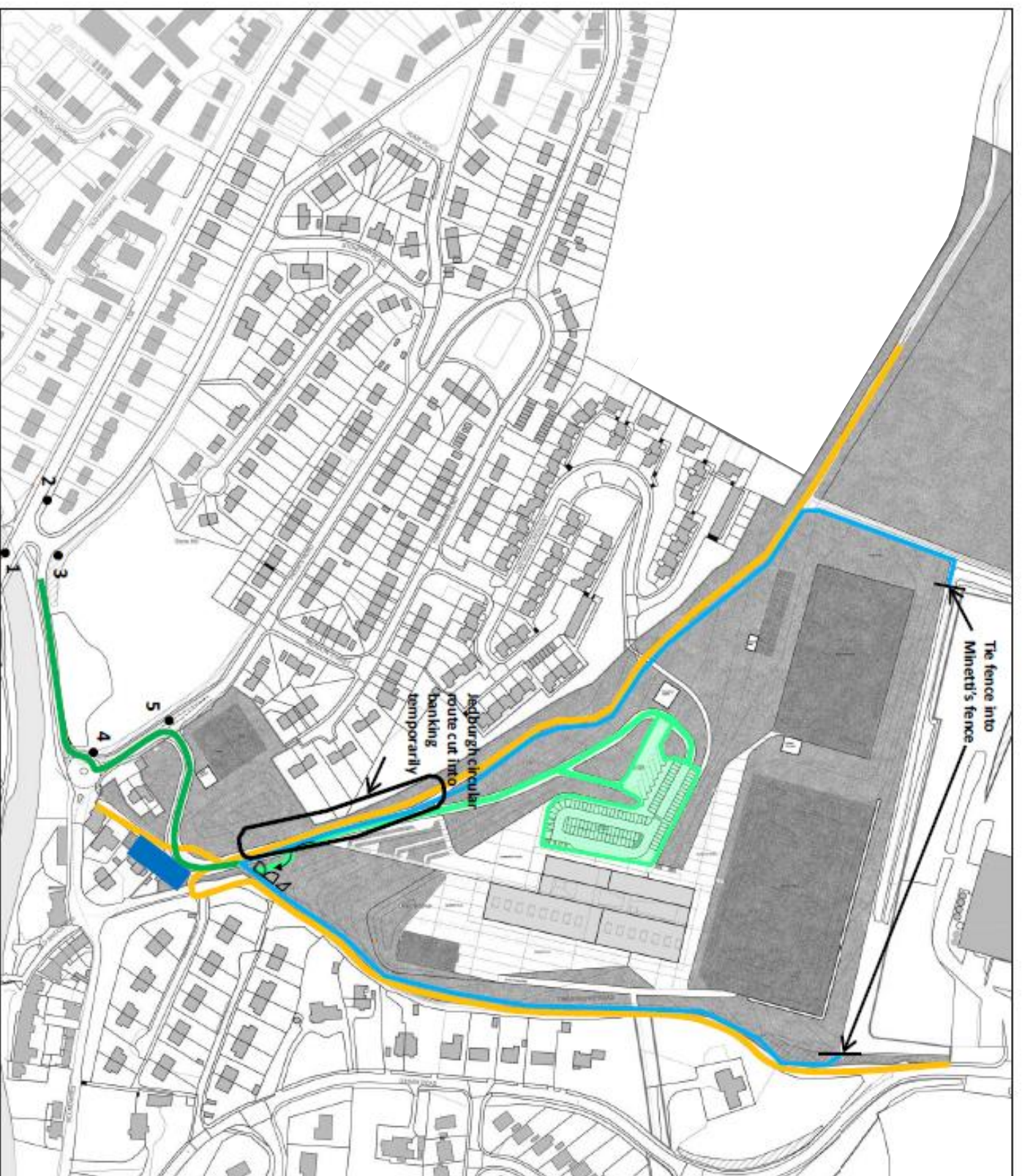

- Jedburgh Circular Route
- Site Access Route
- Permanent Compound
- Vehicle Gate
- Pedestrian Gate
- Metas Fencing
- Turnstile Unit

BAM Directional Signage Guide

- BAM Site Next Right
- BAM Site Next Left
- BAM Site Turn Right
- BAM Site Straight On
- BAM Site Turn Left



Contract

Jedburgh ICC

Drawing Title

Traffic Management Plan
Weeks 30-100

Drawing No.

Revision

Ref: MK/SC Date: 20/01/18

